

Connecting WiFi Stats Using AP Mode



PRO TOUCH
Smart Thermostat

Step 1

On the thermostat press and hold the UP and DOWN arrow together until F2 appears, If the code F1 appears release the UP and Down arrows and repeat the steps. Please note F2 will disappear from the screen and the WiFi icon will begin to flash slowly.

Step 2

Ensure you are connected to your WiFi network and open the ProTouch WiFi application on your device, Once open log in to your account following the steps on screen.

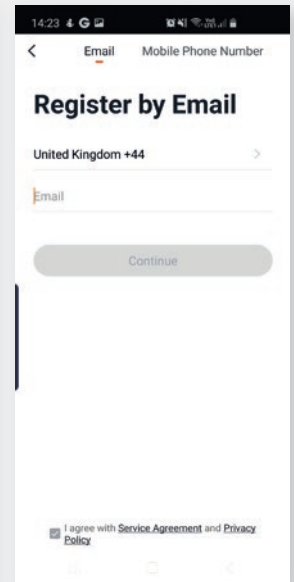
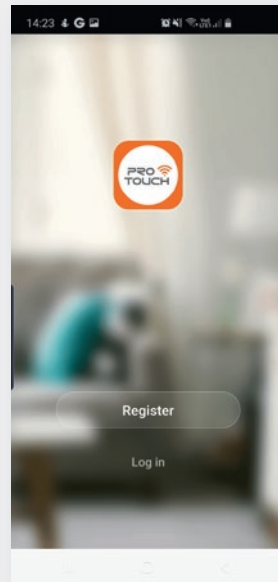
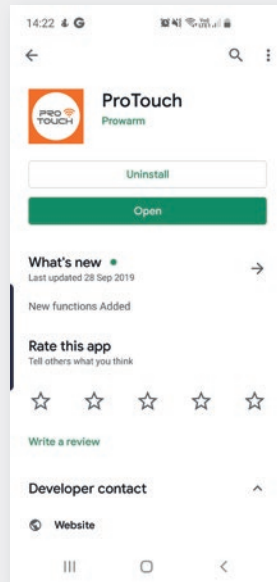

Step 3

In the ProTouch Application press the Plus symbol at the top of the screen to add a new device, select WiFi Thermostat.

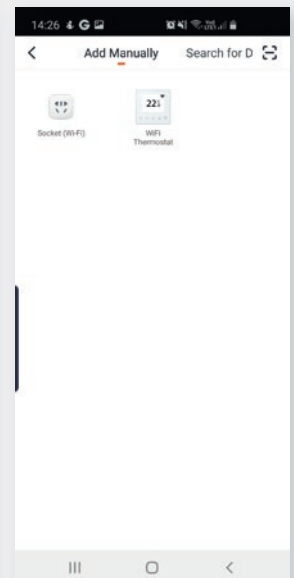
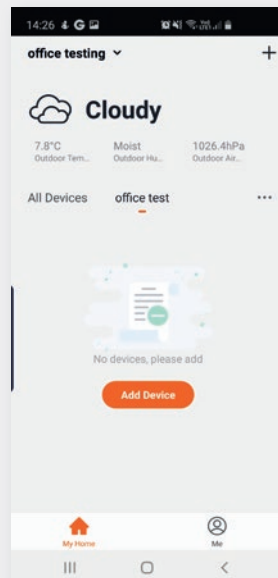

Step 4

On the add device screen you need to select AP Mode in the top right corner, once AP Mode is selected press the orange button “Press to Connect” and enter your WiFi details. Please make sure these details are correct. Ensure you have selected the correct WiFi network and that the password you enter is accurate, as this will not work if miss typed. Press the orange button “Confirm”.

NB: When using an iPhone you will need to click on ‘Otherwise’ followed by AP mode.

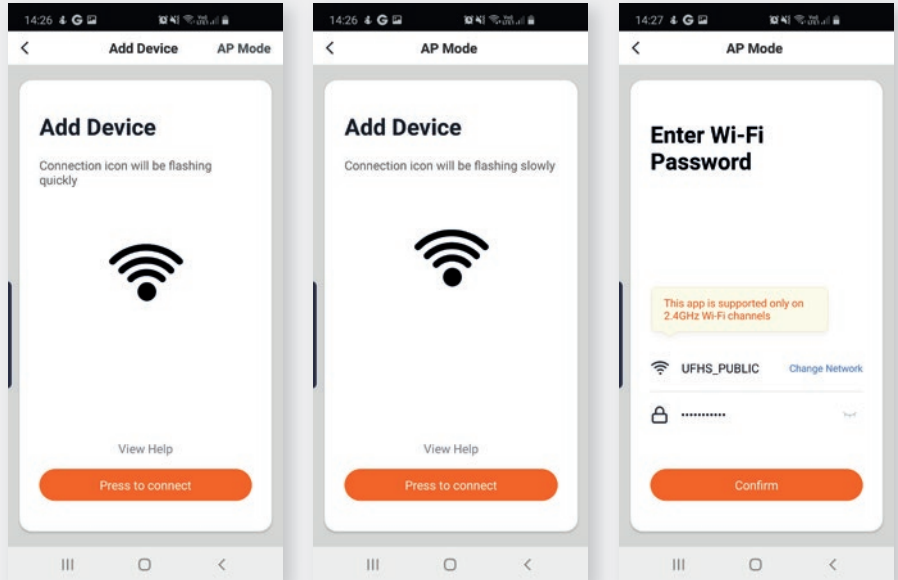

Step 5

Continue following steps that appear on screen pressing the orange button “Go to Connect” this will open your Phones WiFi Settings. Select WiFi hotspot named SMARTLIFE-XXXX, Once connected to SMARTLIFE-XXXX return back to the ProTouch Application.

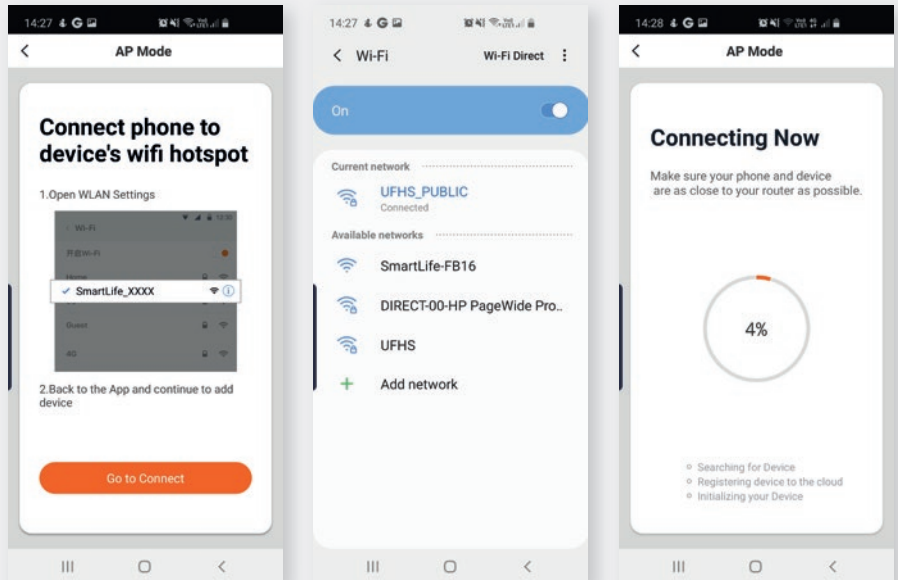

Step 6

Once the connection process is complete press done, a firmware update maybe required. Once complete the thermostat will be accessible via the application

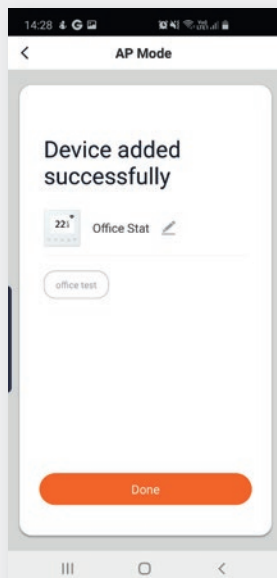

Support: ☎ 01268 567019
www.prowarm.com